

Gleitlagerbüchsen
(Wartungsfrei)
Paliers lisses
(Sans entretien)

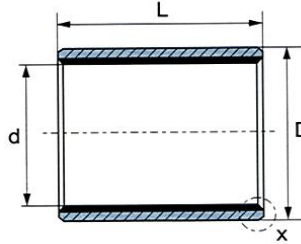

Reihe/Série FB1

Bezeichnung	Masse			Preis
Désignation	Dimensions			Prix
	d	D	L	

0303 FB1	3	4.5	3	0.95
0304 FB1	3	4.5	4	0.95
0305 FB1	3	4.5	5	1.00
0306 FB1	3	4.5	6	1.00
0403 FB1	4	5.5	3	0.95
0404 FB1	4	5.5	4	1.00
0406 FB1	4	5.5	6	1.00
0408 FB1	4	5.5	8	1.00
0410 FB1	4	5.5	10	1.10
0504 FB1	5	7	4	1.00
0505 FB1	5	7	5	1.00
0506 FB1	5	7	6	1.00
0508 FB1	5	7	8	1.10
0510 FB1	5	7	10	1.10
0606 FB1	6	8	6	1.10
0608 FB1	6	8	8	1.10
0610 FB1	6	8	10	1.25
0806 FB1	8	10	6	1.10
0808 FB1	8	10	8	1.10
0810 FB1	8	10	10	1.25
0812 FB1	8	10	12	1.35
1006 FB1	10	12	6	1.55
1008 FB1	10	12	8	1.55
1010 FB1	10	12	10	1.65
1012 FB1	10	12	12	1.75
1015 FB1	10	12	15	1.95

Reihe/Série FB1

Bezeichnung	Masse			Preis
Désignation	Dimensions			Prix
	d	D	L	

1020 FB1	10	12	20	2.20
1206 FB1	12	14	6	2.00
1208 FB1	12	14	8	2.00
1210 FB1	12	14	10	2.10
1212 FB1	12	14	12	2.25
1215 FB1	12	14	15	2.40
1220 FB1	12	14	20	2.75
1225 FB1	12	14	25	3.00
1310 FB1	13	15	10	2.45
1320 FB1	13	15	20	3.00
1410 FB1	14	16	10	2.30
1412 FB1	14	16	12	2.45
1415 FB1	14	16	15	2.70
1420 FB1	14	16	20	2.90
1425 FB1	14	16	25	3.10
1510 FB1	15	17	10	2.30
1512 FB1	15	17	12	2.40
1515 FB1	15	17	15	2.70
1520 FB1	15	17	20	3.05
1525 FB1	15	17	25	3.50
1610 FB1	16	18	10	2.45
1612 FB1	16	18	12	2.70
1615 FB1	16	18	15	2.75
1620 FB1	16	18	20	3.05
1625 FB1	16	18	25	3.60
1712 FB1	17	19	12	2.85

Gleitlagerbüchsen
(Wartungsfrei)
Paliers lisses
(Sans entretien)

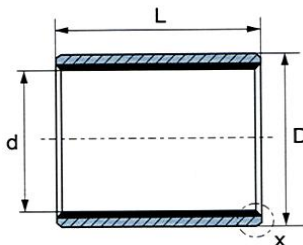

Reihe/Série FB1

Bezeichnung	Masse			Preis
Désignation	Dimensions			Prix
	d	D	L	

1715 FB1	17	19	15	2.85
1720 FB1	17	19	20	3.25
1810 FB1	18	20	10	2.60
1812 FB1	18	20	12	2.85
1815 FB1	18	20	15	2.95
1820 FB1	18	20	20	3.50
1825 FB1	18	20	25	3.90
2010 FB1	20	23	10	2.55
2012 FB1	20	23	12	3.35
2015 FB1	20	23	15	3.10
2020 FB1	20	23	20	3.90
2025 FB1	20	23	25	4.55
2030 FB1	20	23	30	5.05
2210 FB1	22	25	10	3.10
2212 FB1	22	25	12	3.35
2215 FB1	22	25	15	3.40
2220 FB1	22	25	20	4.15
2225 FB1	22	25	25	4.75
2230 FB1	22	25	30	5.15
2415 FB1	24	27	15	3.85
2420 FB1	24	27	20	4.55
2425 FB1	24	27	25	5.45
2430 FB1	24	27	30	6.05
2510 FB1	25	28	10	3.35
2512 FB1	25	28	12	3.85
2515 FB1	25	28	15	3.90

Reihe/Série FB1

Bezeichnung	Masse			Preis
Désignation	Dimensions			Prix
	d	D	L	

2520 FB1	25	28	20	4.75
2525 FB1	25	28	25	5.45
2530 FB1	25	28	30	6.20
2540 FB1	25	28	40	8.40
2550 FB1	25	28	50	10.35
2812 FB1	28	32	12	4.30
2815 FB1	28	32	15	4.55
2820 FB1	28	32	20	5.30
2825 FB1	28	32	25	6.25
2830 FB1	28	32	30	7.00
3012 FB1	30	34	12	4.75
3015 FB1	30	34	15	4.85
3020 FB1	30	34	20	5.45
3025 FB1	30	34	25	6.25
3030 FB1	30	34	30	7.20
3040 FB1	30	34	40	9.15
3220 FB1	32	36	20	6.30
3230 FB1	32	36	30	7.95
3240 FB1	32	36	40	10.05
3512 FB1	35	39	12	4.55
3515 FB1	35	39	15	5.50
3520 FB1	35	39	20	6.25
3525 FB1	35	39	25	7.15
3530 FB1	35	39	30	8.05
3535 FB1	35	39	35	9.80
3540 FB1	35	39	40	10.25

Gleitlagerbüchsen
(Wartungsfrei)
Paliers lisses
(Sans entretien)

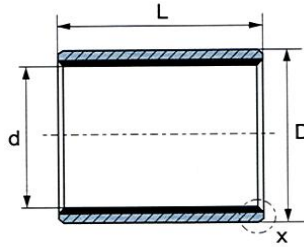

Reihe/Série FB1

Bezeichnung	Masse			Preis
Désignation	Dimensions			Prix
	d	D	L	

3550 FB1	35	39	50	11.45
3555 FB1	35	39	55	13.30
3815 FB1	38	42	15	6.90
3830 FB1	38	42	30	7.80
3840 FB1	38	42	40	11.25
4012 FB1	40	44	12	5.70
4020 FB1	40	44	20	6.80
4025 FB1	40	44	25	8.20
4030 FB1	40	44	30	8.30
4040 FB1	40	44	40	9.65
4050 FB1	40	44	50	11.75
4520 FB1	45	50	20	8.75
4525 FB1	45	50	25	9.25
4530 FB1	45	50	30	10.40
4540 FB1	45	50	40	13.85
4545 FB1	45	50	45	15.80
4550 FB1	45	50	50	15.80
5020 FB1	50	55	20	9.70
5030 FB1	50	55	30	12.50
5040 FB1	50	55	40	14.40
5050 FB1	50	55	50	18.75
5060 FB1	50	55	60	20.65
5520 FB1	55	60	20	12.50
5530 FB1	55	60	30	16.30
5540 FB1	55	60	40	16.95
5550 FB1	55	60	50	20.40

Reihe/Série FB1

Bezeichnung	Masse			Preis
Désignation	Dimensions			Prix
	d	D	L	

5560 FB1	55	60	60	21.15
6020 FB1	60	65	20	15.05
6030 FB1	60	65	30	16.30
6040 FB1	60	65	40	19.85
6050 FB1	60	65	50	23.60
6060 FB1	60	65	60	26.05
6070 FB1	60	65	70	28.90
6530 FB1	65	70	30	19.25
6540 FB1	65	70	40	21.40
6550 FB1	65	70	50	22.95
6560 FB1	65	70	60	28.90
6570 FB1	65	70	70	34.95
7040 FB1	70	75	40	26.40
7050 FB1	70	75	50	30.35
7060 FB1	70	75	60	30.45
7070 FB1	70	75	70	37.20
7080 FB1	70	75	80	39.50
7540 FB1	75	80	40	24.45
7550 FB1	75	80	50	28.20
7560 FB1	75	80	60	36.45
7580 FB1	75	80	80	45.10
8040 FB1	80	85	40	28.00
8050 FB1	80	85	50	32.65
8060 FB1	80	85	60	40.40
8080 FB1	80	85	80	41.95
80100 FB1	80	85	100	53.00

Gleitlagerbüchsen
(Wartungsfrei)
Paliers lisses
(Sans entretien)

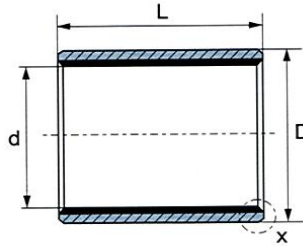

Reihe/Série FB1

Bezeichnung	Masse			Preis
Désignation	Dimensions			Prix
	d	D	L	

8530 FB1	85	90	30	31.55
8540 FB1	85	90	40	32.95
8560 FB1	85	90	60	43.10
85100 FB1	95	90	100	57.85
9040 FB1	90	95	40	34.95
9050 FB1	90	95	50	38.10
9060 FB1	90	95	60	49.95
9090 FB1	90	95	90	59.75
90100 FB1	90	95	100	65.75
9550 FB1	95	100	50	41.40
9560 FB1	95	100	60	54.10
95100 FB1	95	100	100	70.95
10050 FB1	100	105	50	44.60
10060 FB1	100	105	60	47.85
10080 FB1	100	105	80	59.55
100115 FB1	100	105	115	68.30
10560 FB1	105	110	60	64.90
105115 FB1	105	110	115	86.55
11060 FB1	110	115	60	69.10
110115 FB1	110	115	115	89.60
12060 FB1	120	125	60	73.90
120100 FB1	120	125	100	89.85
12560 FB1	125	130	60	89.55
125100 FB1	125	130	100	97.85
13060 FB1	130	135	60	74.40
130100FB1	130	135	100	103.70

Reihe/Série FB1

Bezeichnung	Masse			Preis
Désignation	Dimensions			Prix
	d	D	L	

14060 FB1	140	145	60	87.75
140100 FB1	140	145	100	116.95
15060 FB1	150	155	60	110.35
15080 FB1	150	155	80	120.15
150100 FB1	150	155	100	130.75
16080 FB1	160	165	80	127.60
160100 FB1	160	165	100	139.25
180100 FB1	180	185	100	162.65
20060 FB1	200	205	60	138.20
200100 FB1	200	205	100	187.70
220100 FB1	220	225	100	234.20
260100 FB1	260	265	100	287.55
300100 FB1	300	305	100	329.60

Gleitlagerbunbühren
(Wartungsfrei)
Paliers lisses avec collerette
(Sans entretien)

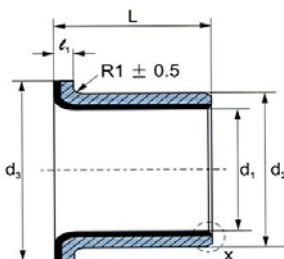

Reihe/Série FB1-F

Bezeichnung Désignation	Masse Dimensions							Preis Prix
	d1	d2	d3	L	l1	R1	x	
03040 FB1-F	3	4.5	7	4	0.75	0.5	0.4	
04040 FB1-F	4	5.5	9	4	0.75	0.5	0.4	
05050 FB1-F	5	7	10	5	1	0.5	0.4	
05060 FB1-F	5	7	10	6	1	0.5	0.4	
06040 FB1-F	6	8	12	4	1	0.5	0.4	1.50
06070 FB1-F	6	8	12	7	1	0.5	0.4	1.65
06090 FB1-F	6	8	12	9	1	0.5	0.4	1.80
08055 FB1-F	8	10	15	5.5	1	0.5	0.4	1.75
08075 FB1-F	8	10	15	7.5	1	0.5	0.4	1.70
08095 FB1-F	8	10	15	9.5	1	0.5	0.4	1.85
10070 FB1-F	10	12	18	7	1	0.5	0.4	2.05
10090 FB1-F	10	12	18	9	1	0.5	0.4	2.15
10120 FB1-F	10	12	18	12	1	0.5	0.4	2.45
10170 FB1-F	10	12	18	17	1	0.5	0.4	3.15
12070 FB1-F	12	14	20	7	1	0.5	0.4	2.50
12090 FB1-F	12	14	20	9	1	0.5	0.4	2.75
12120 FB1-F	12	14	20	12	1	0.5	0.4	2.85
12170 FB1-F	12	14	20	17	1	0.5	0.4	3.40
14120 FB1-F	14	16	22	12	1	0.5	0.4	3.10
14170 FB1-F	14	16	22	17	1	0.5	0.4	3.80
15080 FB1-F	15	17	23	8	1	0.5	0.4	3.35
15120 FB1-F	15	17	23	12	1	0.5	0.4	3.65
15170 FB1-F	15	17	23	17	1	0.5	0.4	4.05

Gleitlagerbunbühren
(Wartungsfrei)
Paliers lisses avec collerette
(Sans entretien)

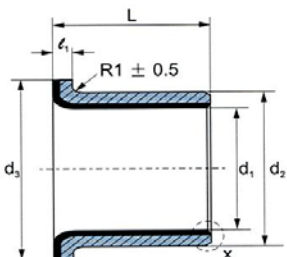

Reihe/Série FB1-F

Bezeichnung Désignation	Masse Dimensions							Preis Prix
	d1	d2	d3	L	l1	R1	x	
16120 FB1-F	16	18	24	12	1	0.5	0.4	3.65
16170 FB1-F	16	18	24	17	1	0.5	0.4	4.05
18120 FB1-F	18	20	26	12	1	0.8	0.4	4.40
18170 FB1-F	18	20	26	17	1	0.8	0.4	4.85
20115 FB1-F	20	23	30	11.5	1.5	0.8	0.4	5.70
20135 FB1-F	20	23	30	13.5	1.5	0.8	0.4	
20165 FB1-F	20	23	30	16.5	1.5	0.8	0.4	6.00
20215 FB1-F	20	23	30	21.5	1.5	0.8	0.4	6.60
22150 FB1-F	22	25	32	15	1.5	0.8	0.4	
22235 FB1-F	22	25	32	23.5	1.5	0.8	0.4	
23135 FB1-F	23	26	33	13.5	1.5	0.8	0.4	
25115 FB1-F	25	28	35	11.5	1.5	0.8	0.4	5.70
25165 FB1-F	25	28	35	16.5	1.5	0.8	0.4	6.45
25215 FB1-F	25	28	35	21.5	1.5	0.8	0.4	8.60
25265 FB1-F	25	28	35	26.5	1.5	0.8	0.4	
30160 FB1-F	30	34	42	16	2	0.8	0.4	9.65
30260 FB1-F	30	34	42	26	2	1	0.5	11.60
35160 FB1-F	35	39	47	16	2	1	0.5	11.00
35260 FB1-F	35	39	47	26	2	1	0.5	13.45
40260 FB1-F	40	44	53	26	2	1	0.5	15.00
45320 FB1-F	45	49	54	32	2	1	0.5	
50220 FB1-F	50	54	60	22	2	1	0.5	
60325 FB1-F	60	65	75	32.5	2.5	1	0.5	
60425 FB1-F	60	65	75	42.5	2.5	1	0.5	

Gleitlagerbüchsen
(mit Schmierertaschen)
Paliers lisses
(avec poche de graissage)

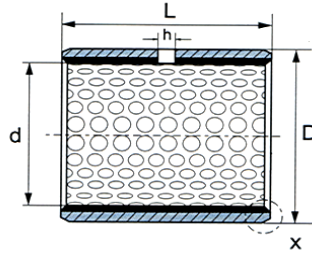

Reihe/Série FB2

Bezeichnung	Masse			Preis
Désignation	Dimensions			Prix
	d	D	L	

1010 FB2	10	12	10	1.30
1012 FB2	10	12	12	1.45
1015 FB2	10	12	15	1.85
1020 FB2	10	12	20	2.30
1210 FB2	12	14	10	1.95
1212 FB2	12	14	12	2.00
1215 FB2	12	14	15	2.25
1220 FB2	12	14	20	2.55
1225 FB2	12	14	25	2.85
1410 FB2	14	16	10	1.95
1412 FB2	14	16	12	2.20
1415 FB2	14	16	15	2.30
1420 FB2	14	16	20	2.50
1425 FB2	14	16	25	3.40
1510 FB2	15	17	10	2.40
1512 FB2	15	17	12	2.45
1515 FB2	15	17	15	2.50
1520 FB2	15	17	20	2.85
1525 FB2	15	17	25	3.25
1610 FB2	16	18	10	2.10
1612 FB2	16	18	12	2.40
1615 FB2	16	18	15	2.60
1620 FB2	16	18	20	2.85
1625 FB2	16	18	25	3.20
1810 FB2	18	20	10	2.40
1812 FB2	18	20	12	2.45

Reihe/Série FB2

Bezeichnung	Masse			Preis
Désignation	Dimensions			Prix
	d	D	L	

1815 FB2	18	20	15	2.50
1820 FB2	18	20	20	2.85
1825 FB2	18	20	25	3.40
2010 FB2	20	23	10	2.30
2012 FB2	20	23	12	2.45
2015 FB2	20	23	15	2.60
2020 FB2	20	23	20	3.20
2025 FB2	20	23	25	3.80
2030 FB2	20	23	30	4.35
2210 FB2	22	25	10	2.75
2212 FB2	22	25	12	2.85
2215 FB2	22	25	15	2.95
2220 FB2	22	25	20	3.20
2225 FB2	22	25	25	3.90
2230 FB2	22	25	30	4.80
2510 FB2	25	28	10	2.95
2512 FB2	25	28	12	3.20
2515 FB2	25	28	15	3.55
2520 FB2	25	28	20	4.35
2525 FB2	25	28	25	4.60
2530 FB2	25	28	30	5.15
2550 FB2	25	28	50	6.10
2815 FB2	28	32	15	5.30
2820 FB2	28	32	20	5.55
2825 FB2	28	32	25	6.45
2830 FB2	28	32	30	6.25

Gleitlagerbüchsen
(mit Schmierertaschen)
Paliers lisses
(avec poche de graissage)

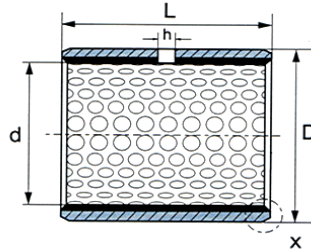

Reihe/Série FB2

Bezeichnung	Masse			Preis
Désignation	Dimensions			Prix
	d	D	L	

3012 FB2	30	34	12	4.00
3015 FB2	30	34	15	4.15
3020 FB2	30	34	20	4.60
3025 FB2	30	34	25	5.25
3030 FB2	30	34	30	5.85
3035 FB2	30	34	35	7.50
3040 FB2	30	34	40	8.75
3512 FB2	35	39	12	4.15
3515 FB2	35	39	15	5.00
3520 FB2	35	39	20	5.65
3530 FB2	35	39	30	6.65
3535 FB2	35	39	35	7.70
3540 FB2	35	39	40	8.50
3550 FB2	35	39	50	9.40
4012 FB2	40	44	12	4.75
4020 FB2	40	44	20	5.30
4025 FB2	40	44	25	6.25
4030 FB2	40	44	30	6.40
4040 FB2	40	44	40	7.85
4050 FB2	40	44	50	9.50
4520 FB2	45	50	20	9.15
4525 FB2	45	50	25	9.40
4530 FB2	45	50	30	10.40
4540 FB2	45	50	40	11.60
4545 FB2	40	50	45	12.25
4550 FB2	40	50	50	13.00

Reihe/Série FB2

Bezeichnung	Masse			Preis
Désignation	Dimensions			Prix
	d	D	L	

5020 FB2	50	55	20	9.50
5030 FB2	50	55	30	10.50
5040 FB2	50	55	40	12.40
5050 FB2	50	55	50	14.00
5060 FB2	50	55	60	16.80
5520 FB2	55	60	20	12.95
5525 FB2	55	60	25	13.45
5530 FB2	55	60	30	14.10
5540 FB2	55	60	40	15.45
5550 FB2	55	60	50	17.70
5560 FB2	55	60	60	19.90
6020 FB2	60	65	20	14.30
6030 FB2	60	65	30	15.40
6040 FB2	60	65	40	16.00
6050 FB2	60	65	50	19.70
6060 FB2	60	65	60	23.45
6070 FB2	60	65	70	25.40
6540 FB2	65	70	40	19.90
6550 FB2	65	70	50	21.75
6560 FB2	65	70	60	24.75
6570 FB2	65	70	70	28.05
7040 FB2	70	75	40	21.20
7050 FB2	70	75	50	24.20
7060 FB2	70	75	60	27.00
7065 FB2	70	75	65	27.10
7070 FB2	70	75	70	29.85

Gleitlagerbüchsen
(mit Schmierertaschen)
Paliers lisses
(avec poche de graissage)

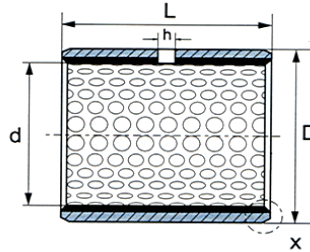

Reihe/Série FB2

Bezeichnung	Masse			Preis
Désignation	Dimensions			Prix
	d	D	L	

7080 FB2	70	75	80	33.65
7540 FB2	75	80	40	23.45
7550 FB2	75	80	50	26.20
7560 FB2	75	80	60	28.95
7580 FB2	75	80	80	33.85
8040 FB2	80	85	40	25.35
8050 FB2	80	85	50	28.30
8060 FB2	80	85	60	31.15
8080 FB2	80	85	80	37.30
8090 FB2	80	85	90	42.60
80100 FB2	80	85	100	42.85
8530 FB2	85	90	30	27.25
8540 FB2	85	90	40	28.10
8560 FB2	85	90	60	33.75
8580 FB2	85	90	80	42.45
85100 FB2	85	90	100	49.40
9040 FB2	90	95	40	33.50
9050 FB2	90	95	50	36.00
9060 FB2	90	95	60	38.50
9080 FB2	90	95	80	49.15
9090 FB2	90	95	90	53.65
90100 FB2	90	95	100	57.30
9560 FB2	95	100	60	42.95
95100 FB2	95	100	100	62.05
10050 FB2	100	105	50	43.10
10060 FB2	100	105	60	46.20

Reihe/Série FB2

Bezeichnung	Masse			Preis
Désignation	Dimensions			Prix
	d	D	L	

10080 FB2	100	105	80	52.10
10095 FB2	100	105	95	56.70
100115 FB2	100	105	115	59.70
10560 FB2	105	110	60	62.45
105110 FB2	105	110	110	76.30
105115 FB2	105	110	115	86.40
11060 FB2	110	115	60	60.60
110110 FB2	110	115	110	77.65
110115 FB2	110	115	115	90.40
11550 FB2	115	120	50	48.90
11570 FB2	115	120	70	72.10
12060 FB2	120	125	60	73.20
120100 FB2	120	125	100	91.85
125100 FB2	125	130	100	97.60
13050 FB2	130	135	50	81.90
13060 FB2	130	135	60	86.40
13080 FB2	130	135	80	95.55
130100 FB2	130	135	100	103.35
13560 FB2	135	140	60	85.75
13580 FB2	135	140	80	96.65
14060 FB2	140	145	60	87.55
140100 FB2	140	145	100	100.15
15050 FB2	150	155	50	93.80
15060 FB2	150	155	60	95.25
15080 FB2	150	155	80	103.35
150100 FB2	150	155	100	106.85

Gleitlagerbüchsen
(mit Schmierertaschen)
Paliers lisses
(avec poche de graissage)

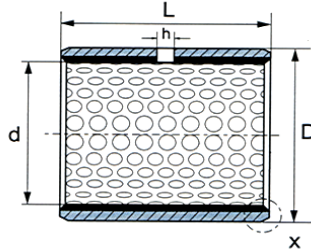

Reihe/Série FB2

Bezeichnung	Masse	Dimensions		Preis	
Désignation		d	D	L	Prix

160100 FB2	160	165	100	148.45
17050 FB2	170	175	50	133.65
17080 FB2	170	175	80	170.15
180100 FB2	180	185	100	176.90

Reihe/Série FB2

Bezeichnung	Masse	Dimensions		Preis	
Désignation		d	D	L	Prix

19060 FB2	190	195	60	190.65
20060 FB2	200	205	60	189.25
20080 FB2	200	205	80	190.65
200100 FB2	200	205	100	218.15

Staffelpreise

1-9 Stück netto
 10-24 Stück 10 % Rabatt
 25-49 Stück 15 % Rabatt
 50-99 Stück 20 % Rabatt

Grössere Mengen auf Anfrage

Prix échelonner

1-9 pièces prix net
 10-24 pièces 10 % rabais
 25-49 pièces 15 % rabais
 50-99 pièces 20 % rabais

Des quantités plus grandes sur demande.

Anlaufscheiben Disques lisses

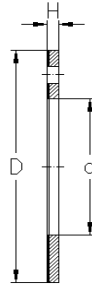

Reihe/Série WC..FB

Bezeichnung Désignation	Abmessungen Dimensions				Preis Prix
	d1	d	D	H	
WC 10 FB	8	10	20	1.5	2.40
WC 12 FB	10	12	24	1.5	1.95
WC 14 FB	12	14	26	1.5	2.10
WC 16 FB	14	16	30	1.5	2.30
WC 18 FB	16	18	32	1.5	2.40
WC 20 FB	18	20	36	1.5	2.75
WC 22 FB	20	22	38	1.5	2.95
WC 24 FB	22	24	42	1.5	3.25
WC 26 FB	24	26	44	1.5	3.40
WC 28 FB	25	28	48	1.5	4.00
WC 32 FB	30	32	54	1.5	5.15
WC 38 FB	35	38	62	1.5	6.05
WC 42 FB	40	42	66	1.5	6.75
WC 48 FB	45	48	74	2	11.15
WC 52 FB	50	52	80	2	12.70
WC 62 FB	60	62	90	2	20.30

*d1 = für Wellendurchmesser

*d1 = pour diamètre arbre